

MOTORCYCLE LEAD-ACID BATTERY

C50-N18L-A3

12V 20Ah

TYPE		C50-N18L-A3	
NOMINAL VOLTAGE		12V	
NOMINAL CAPACITY		20AH/10HR	
DIMENSIONS			
LENGTH	204.5 mm	TOTAL LENGTH	204.5 mm
WIDTH	90.0 mm	TOTAL WIDTH	90.0 mm
HEIGHT	161.5 mm	TOTAL HEIGHT	161.5 mm
WEIGHT		APPROX. 4.83 KGS	

Dimension

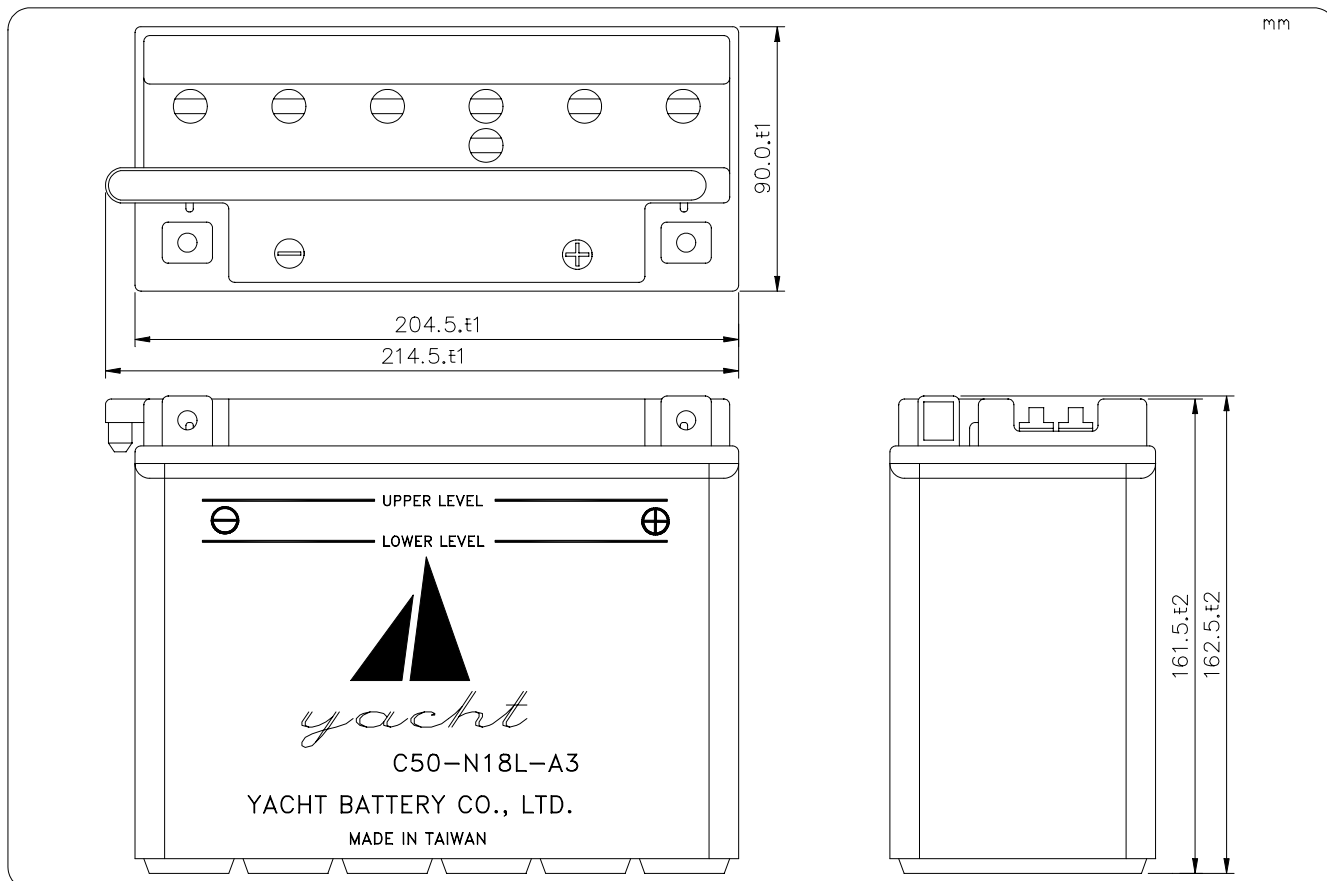

Terminal

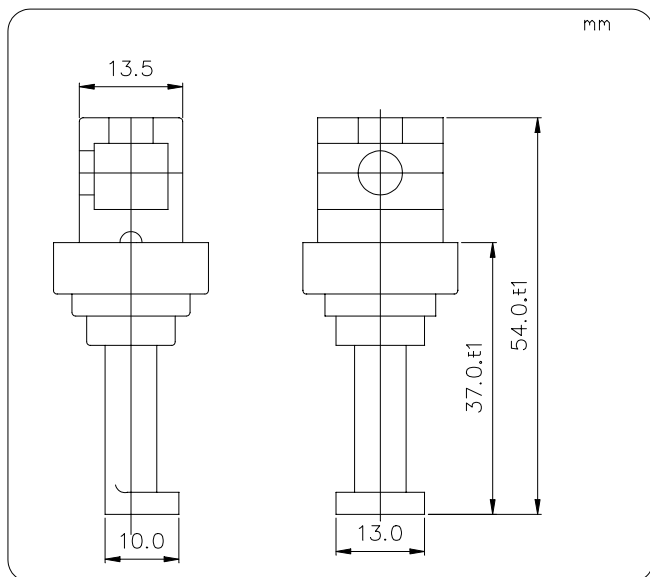

Screw

