

# MOTORCYCLE LEAD-ACID BATTERY

**CB16AL-A2**

**12V 16Ah**

TYPE		CB16AL-A2	
NOMINAL VOLTAGE		12V	
NOMINAL CAPACITY		16AH/10HR	
DIMENSIONS			
LENGTH	204.0 mm	TOTAL LENGTH	204.0 mm
WIDTH	70.0 mm	TOTAL WIDTH	70.0 mm
HEIGHT	164.0 mm	TOTAL HEIGHT	164.0 mm
WEIGHT		APPROX. 4.1 KGS	

Dimension

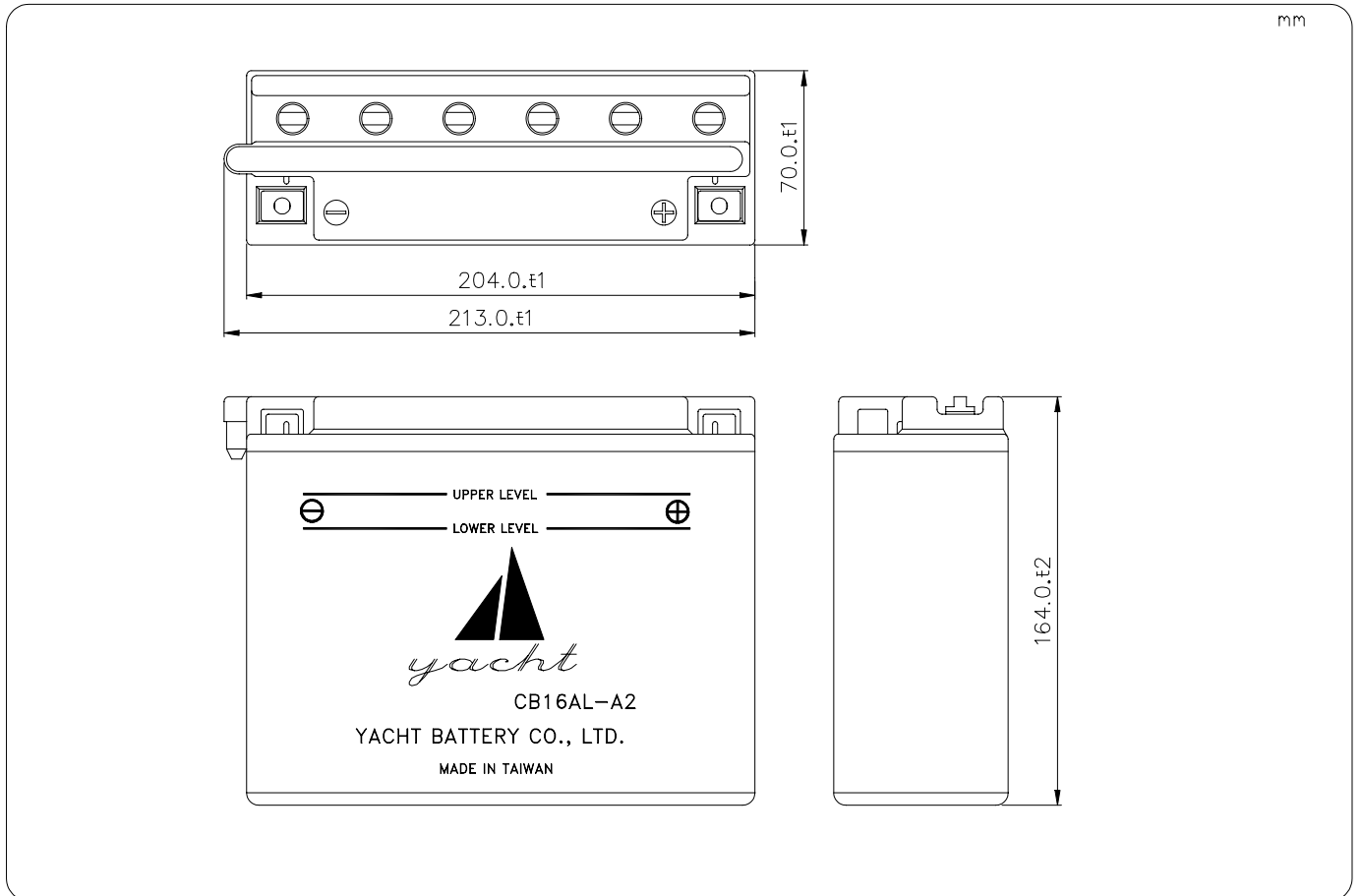

Terminal

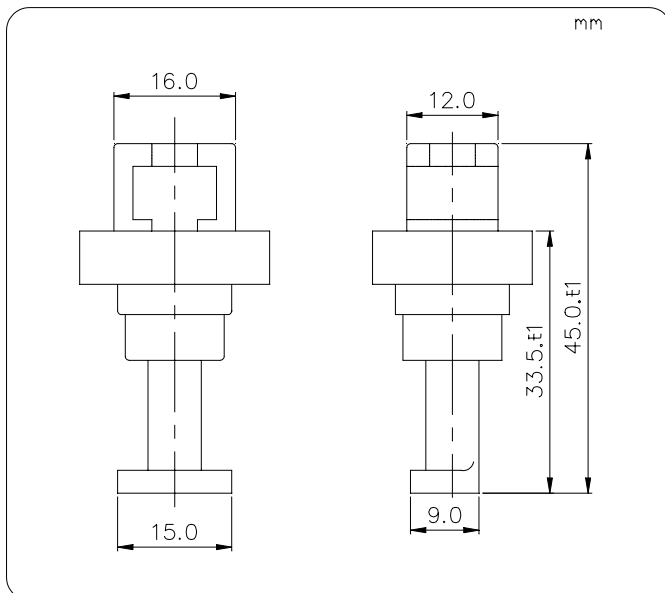

Screw

